

ATLANTIS MARINE WORLD, RIVERHEAD, NY

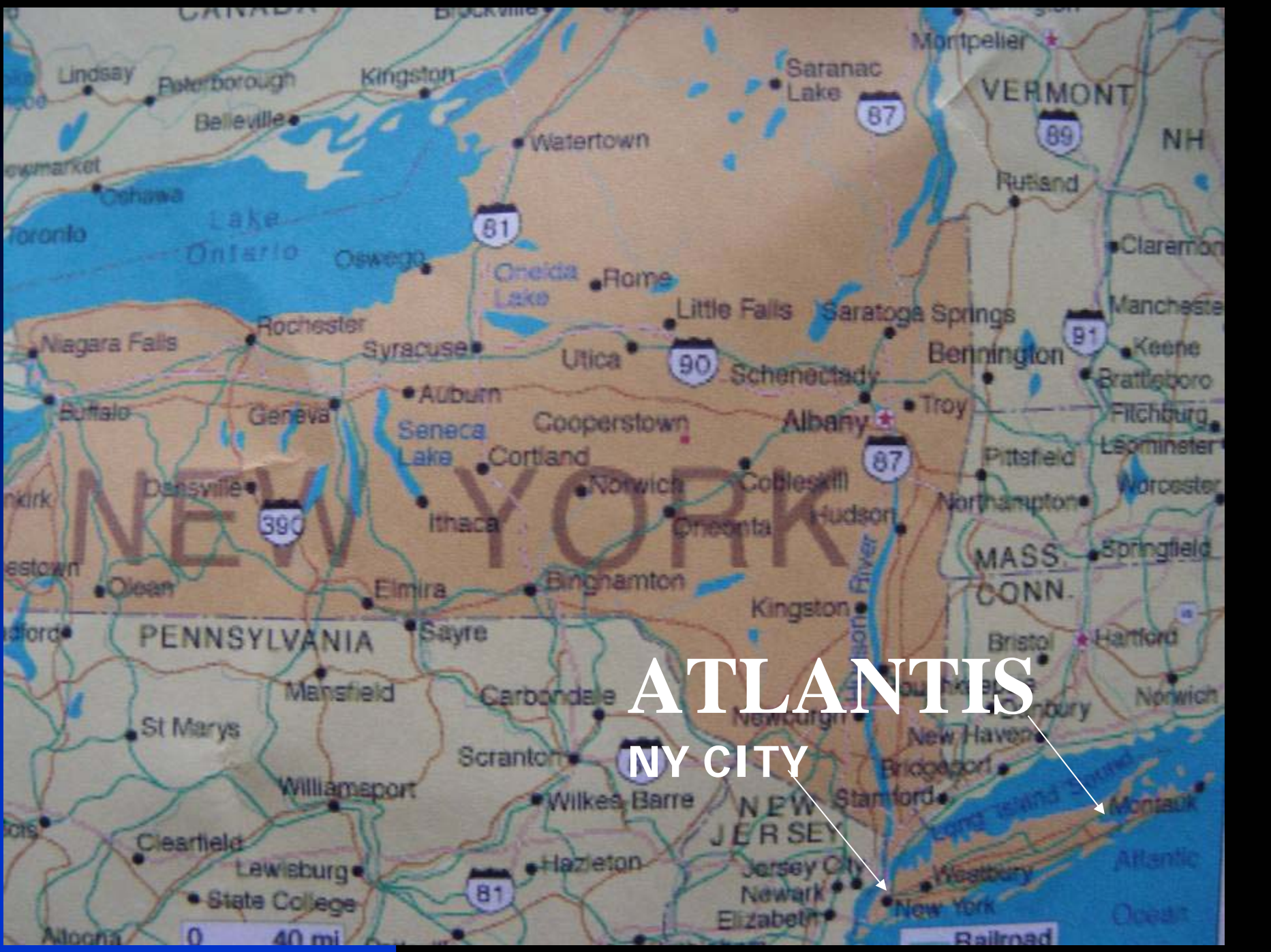

**Planning, Building and
Maintaining a 20,000
Gallon Reef Tank.**



NEW YORK

ATLANTIS
NY CITY

0 40 mi

Broadway

Atlantic Ocean



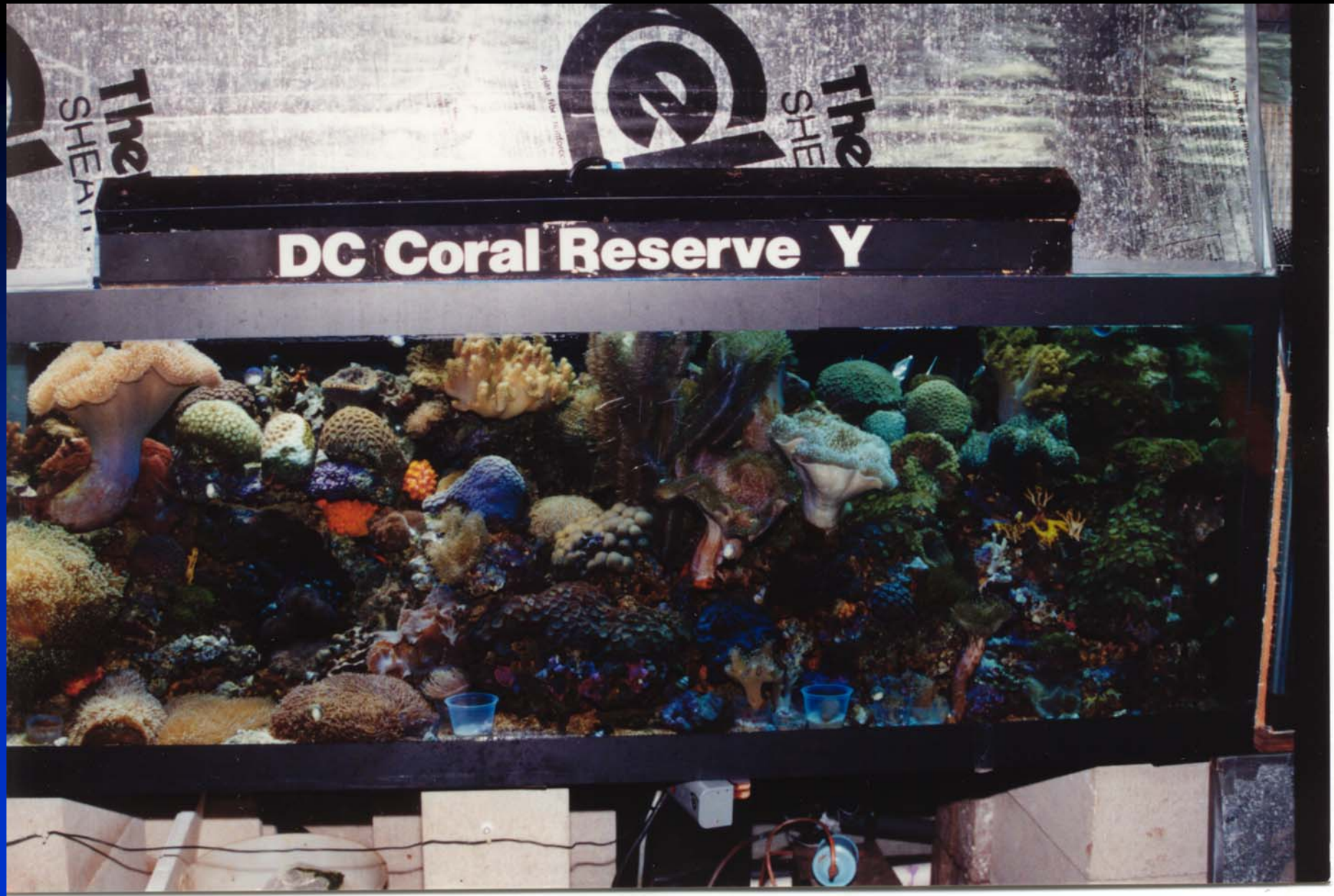



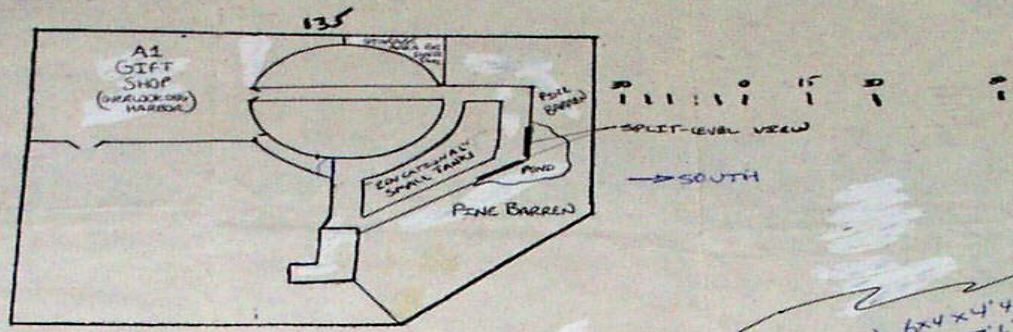

-16,000 sq

780 GALLON 6x4x4'4" = 5 Pools
 1150 " 12x3'6" x 3'8" = 954
 2200 " 12x7x3'6" = 9500
 High rate sand filter w/
 Trickle towers ~ 400-600

BUTTON MAKING
 VOLUNTEER STAFF
 1981-1992 40,822.69

TEACHER TRAINING WORKSHOPS
 2 INSTRUCTORS PER WORKSHOP / 1 DAY
 9 Groups 2 Individuals
 12 38%
 REVENUE \$20,608

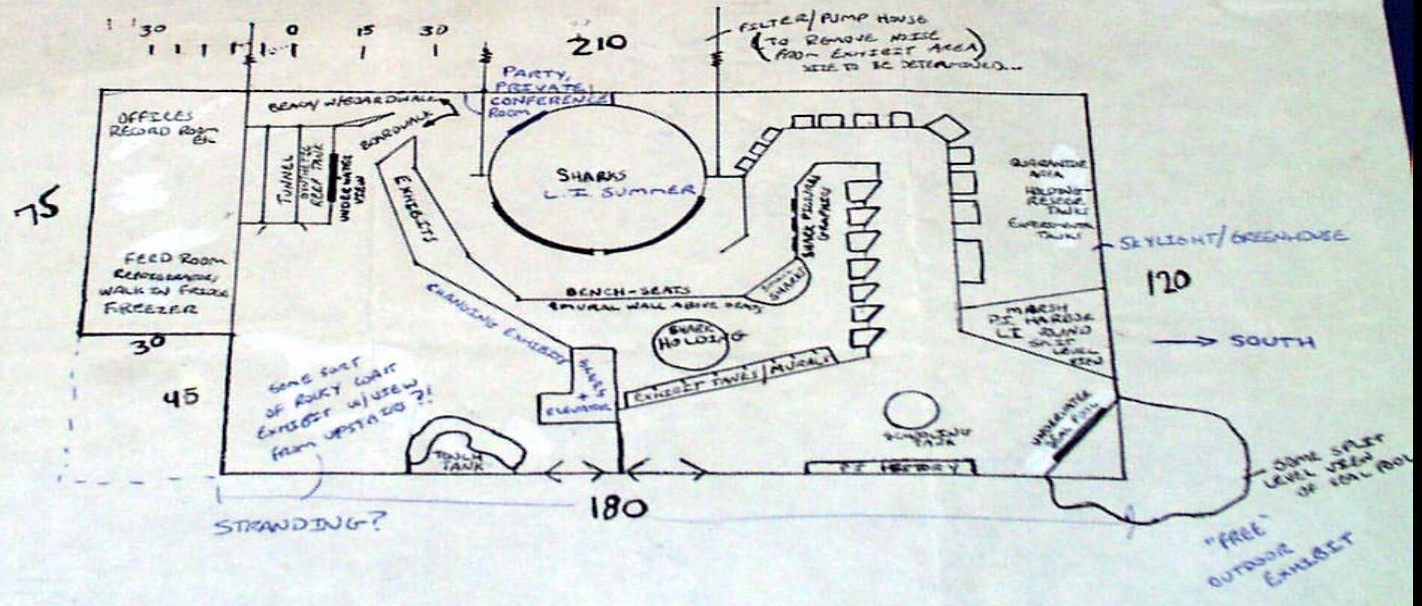



***MANY CHILD LABOR LAWS WERE SIMPLY IGNORED
TO GET THE JOB DONE ON TIME...***

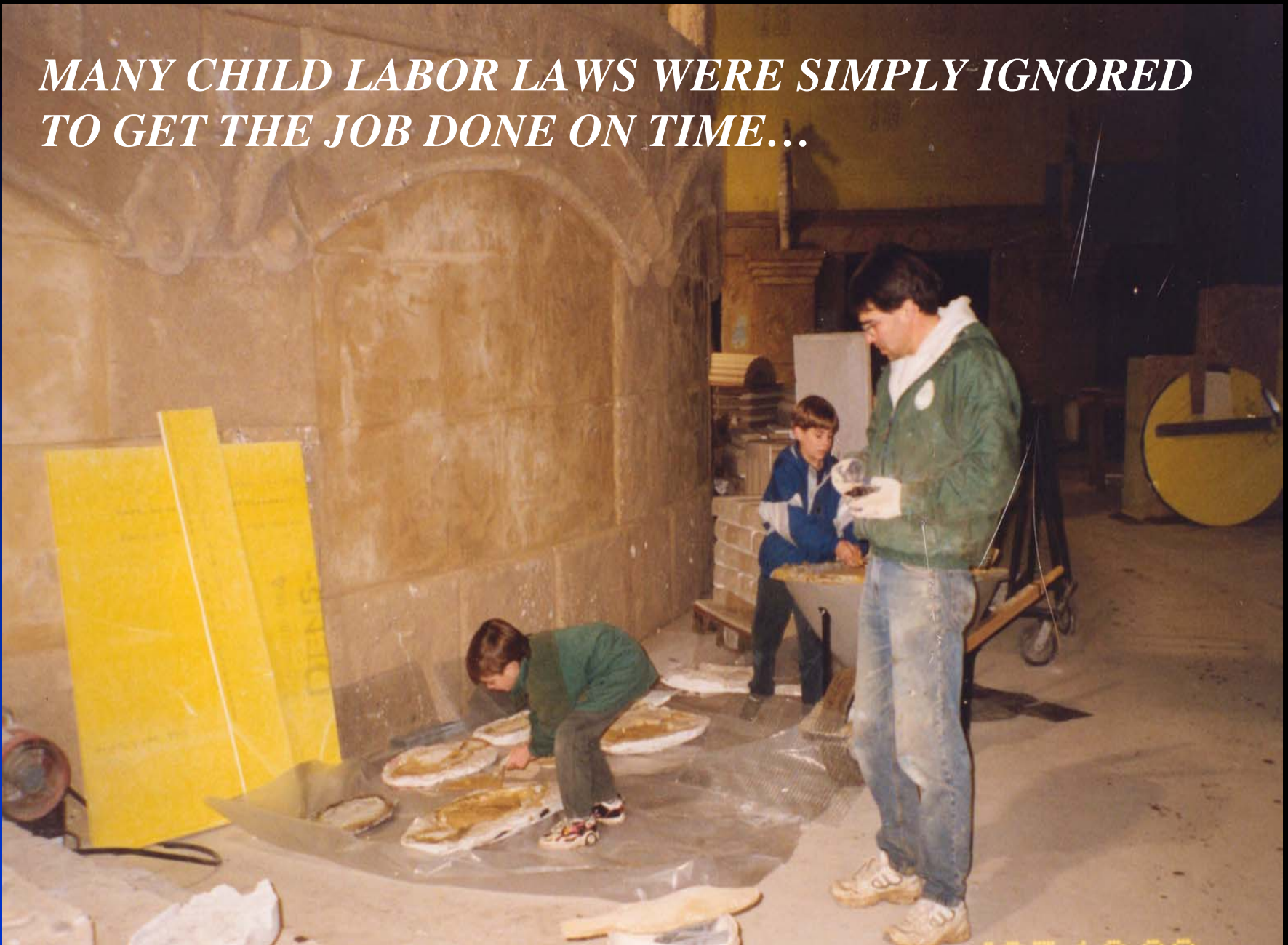



Atlantis

MARINE WORLD (561) 208-9200
RIVERHEAD, FL.









Atlantis Cafe
Elevator
→

ING CORAL REEF



An educational poster titled "ING CORAL REEF" is mounted on the left wall. It features several illustrations of coral reef organisms, including various species of fish and coral structures. The text on the poster is partially obscured but appears to be informative about the reef ecosystem.







Jonathan Hale



Exhibit
Designed in
Progress

Jonathan Hale





PROBLEMS?

NOT A ONE.

**IT HAS ALL WORKED
PERFECTLY FROM
THE DAY ONE...**







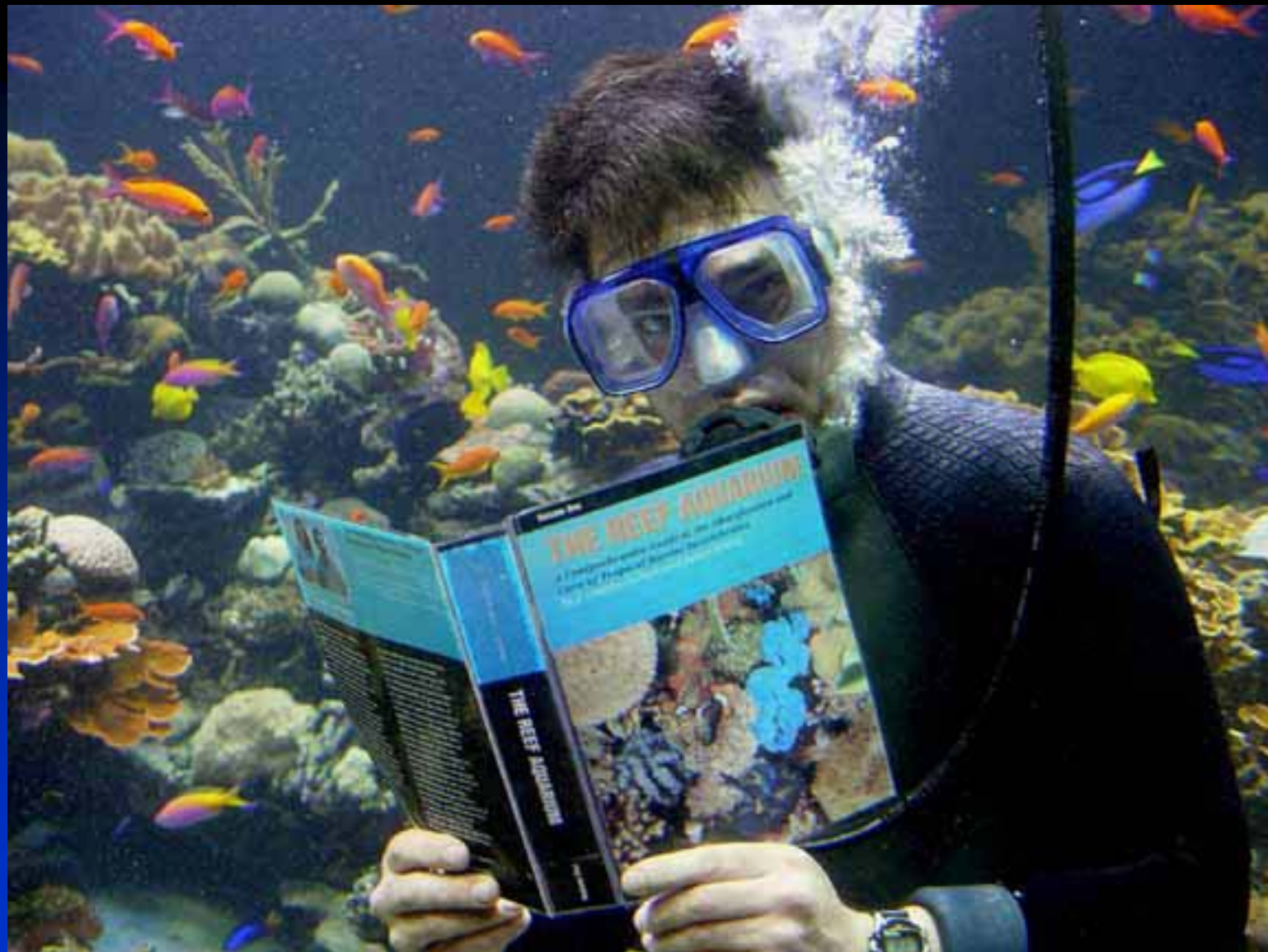







Calcium reactors (6" diameter x 5' tall)



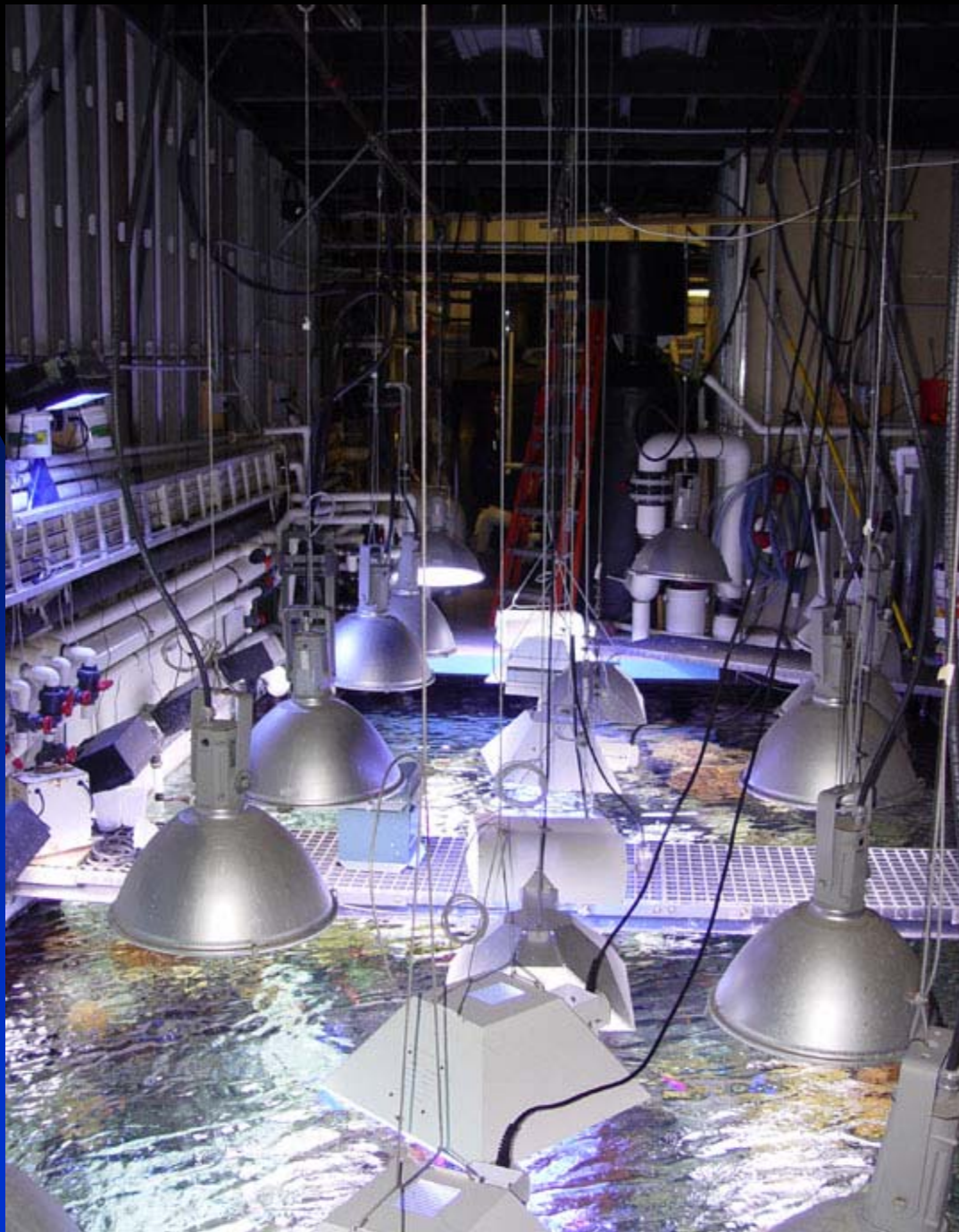

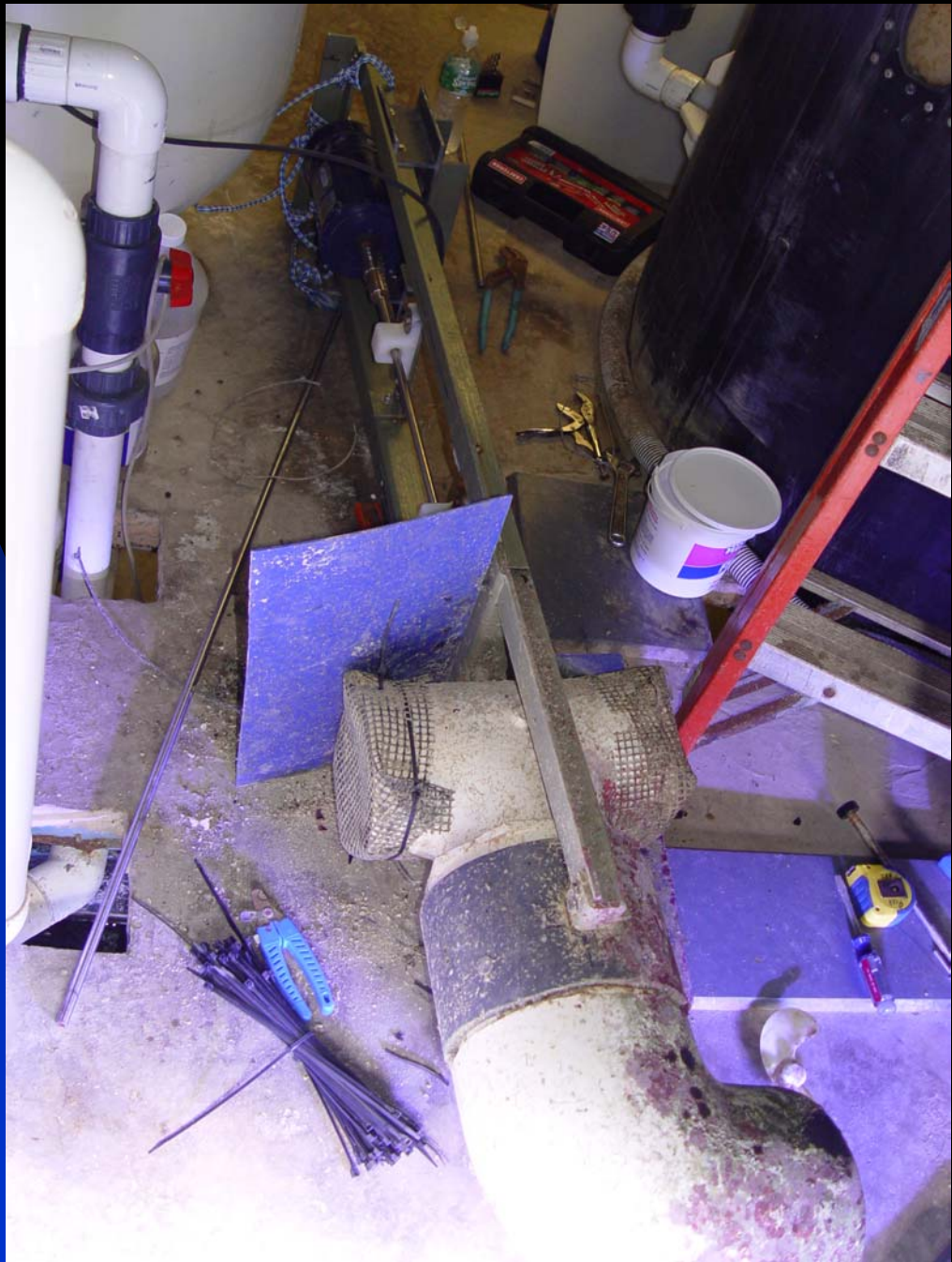









We do all the hard work for the children...

